

# Reichert® 7 Series Chinrest Installation Procedure



# Contents

Warnings & Cautions .....	3
Symbol Information.....	4
Introduction.....	5
Instrument Setup	
Unpacking Instructions .....	6
Parts Identification .....	6
Installation .....	7
Instructions for Use	
Chinrest Operation.....	8
Cleaning & Maintenance	
External Cleaning .....	9
Troubleshooting .....	9
General Specifications .....	10
Warranty.....	11

©2020 AMETEK, Inc.

Reichert, Reichert Technologies, and Ocular Response Analyzer are registered trademarks of Reichert, Inc.

AMETEK is a registered trademark of AMETEK, Inc.

All other trademarks are property of their respective owners.

The information contained in this document was accurate at time of publication. Specifications subject to change without notice. Reichert, Inc. reserves the right to make changes in the product described in this manual without notice and without incorporating those changes in any products already sold.

ISO 13485 Certified – Reichert products are designed and manufactured under quality processes meeting ISO 13485 requirements.

No part of this publication may be reproduced, stored in a retrieval system, or transmitted in any form or by any means, electronic, mechanical, recording, or otherwise, without the prior written permission of Reichert, Inc.

**Caution: Federal law restricts this device to sale by or on the order of a licensed physician. Rx only.**

# Warnings & Cautions

Reichert Technologies® is not responsible for the safety and reliability of this instrument when:

- Assembly, disassembly, repair, or modification is made by unauthorized dealers or persons
- Instrument is not used in accordance with this User's Guide.

## **WARNING: AN INSTRUCTION THAT DRAWS ATTENTION TO RISK OF INJURY OR DEATH.**



**WARNING:** UNITED STATES FEDERAL LAW AND EUROPEAN REGULATIONS REQUIRE THAT THIS DEVICE BE PURCHASED ONLY BY A PHYSICIAN OR A PERSON ACTING ON BEHALF OF A PHYSICIAN.

**WARNING:** THIS INSTRUMENT SHOULD BE USED IN STRICT ACCORDANCE WITH THE INSTRUCTIONS OUTLINED IN THIS USER'S GUIDE. THE SAFETY OF THE OPERATOR AND THE PERFORMANCE OF THE INSTRUMENT CANNOT BE GUARANTEED IF USED IN A MANNER NOT SPECIFIED BY REICHERT TECHNOLOGIES.

**WARNING:** DO NOT REPAIR OR SERVICE THIS INSTRUMENT WITHOUT AUTHORIZATION FROM THE MANUFACTURER. ANY REPAIR OR SERVICE TO THIS INSTRUMENT MUST BE PERFORMED BY EXPERIENCED PERSONNEL OR DEALERS WHO ARE TRAINED BY REICHERT SO THAT CORRECT OPERATION OF THIS INSTRUMENT IS MAINTAINED OR SERIOUS INJURY TO THE OPERATOR OR PATIENT MAY OCCUR.

**WARNING:** MODIFICATIONS TO THIS INSTRUMENT ARE NOT ALLOWED. ANY MODIFICATION TO THIS UNIT MUST BE AUTHORIZED BY REICHERT SO THAT CORRECT OPERATION IS MAINTAINED OR SERIOUS INJURY TO THE OPERATOR OR PATIENT MAY OCCUR.

**WARNING:** IF THIS INSTRUMENT IS MODIFIED, APPROPRIATE INSPECTION AND TESTING MUST BE CONDUCTED TO ENSURE CONTINUED SAFE USE OF THIS INSTRUMENT.

**WARNING:** ENSURE THAT THE VOLTAGE APPLIED TO THE UNIT IS THE SAME AS THE VOLTAGE THAT IS INDICATED ON THE DATA PLATE OR DAMAGE TO THE INSTRUMENT AND/OR INJURY TO THE OPERATOR OR PATIENT MAY OCCUR.

**WARNING:** THE AREA BELOW THE CHINREST MAY CREATE A "PINCH HAZARD." DO NOT PLACE FINGERS BETWEEN THE CHINREST AND THE CHINREST BASE OR INJURY MAY OCCUR WHEN THE CHINREST IS LOWERED.

## **CAUTION: AN INSTRUCTION THAT DRAWS ATTENTION TO RISK OF PRODUCT DAMAGE.**



**CAUTION:** THE INTERNAL CIRCUITRY OF THE INSTRUMENT CONTAINS ELECTROSTATIC DISCHARGE SENSITIVE DEVICES (ESDS) THAT MAY BE SENSITIVE TO STATIC CHARGES PRODUCED BY THE HUMAN BODY. DO NOT REMOVE THE COVERS WITHOUT TAKING PROPER PRECAUTIONS.

**CAUTION:** DO NOT USE SOLVENTS OR STRONG CLEANING SOLUTIONS ON ANY PART OF THIS INSTRUMENT AS DAMAGE TO THE UNIT MAY OCCUR. SEE MAINTENANCE SECTION FOR DETAILED CLEANING INSTRUCTION.

**CAUTION:** THIS INSTRUMENT IS NOT INTENDED TO BE CONNECTED TO EQUIPMENT OUTSIDE THE CONTROL OF REICHERT INC. OR MUST BE TESTED TO AN APPLICABLE IEC OR ISO STANDARDS.

**CAUTION:** DO NOT AUTOCLAVE OR DISINFECT USING HIGH TEMPERATURES EXCEEDING THE RECOMMENDED TEMPERATURES INDICATED IN THE SPECIFICATIONS SECTION OF THIS MANUAL OR DAMAGE TO THE UNIT MAY OCCUR.

# Symbol Information

## Symbol Information

The following symbols appear on the instrument:



Caution symbol indicating important operating and maintenance instructions that are included in this User's Guide.



Type B Applied Part



Protective Earth Connection



Date of Manufacture

REF

Catalog Number

SN

Serial Number



Waste of Electrical and Electronic Equipment



Compliance to Medical Device Directive 93/42/EEC



Accompanying Documents must be consulted



Authorized Representative in European Community



Fragile Contents in Shipping Container - handle with care



Keep Dry - Package shall be kept away from rain

# Introduction

Congratulations on your purchase of the Reichert® 7 Series Chinrest.

This User's Guide is designed as a training and reference manual for operation, maintenance, and troubleshooting. We recommend that you read it carefully prior to use and follow the instructions in the guide to ensure optimum performance of your new instrument. Properly trained eyecare professionals such as ophthalmologists, optometrists, opticians and eye care technicians should operate this instrument.

Please retain this guide for future reference and to share with other users. Additional copies can be obtained from your authorized Reichert, Inc. dealer or contact our Customer Service department directly at the address on the back cover:

Tel: 716-686-4500

Fax: 716-686-4545

E-mail: [reichert.information@ametek.com](mailto:reichert.information@ametek.com)

## Indications for use

This device is an accessory for a tonometer which measures intraocular pressure to aid in the screening and diagnosis of glaucoma.

## Contraindications

None

# Instrument Setup

## Unpacking Instructions

Great care has been taken to deliver your new Reichert 7 Series Chinrest to you safely. Please read the User's Guide before operating the unit.

Remove the following contents from its box.

- Chinrest Assembly
- Hardware Package
- User Guide (P/N 16049-101)
- Up/Down Switch (P/N 16049-815\*)  
(\*Note: maximum length not to exceed 36 inches (92.0 cm))

## Parts Identification

(Refer to Figure 1-1)

1. Chinrest Assembly: Chinrest that the patient can use as a support during measurements.
2. Chinrest Mounting Bracket: Bracket of the Chinrest that attaches to the underside of the Reichert 7.
3. Mounting Hardware: Hardware for the Chinrest and switch.
  - 4 screws:  
(attaches the chinrest mounting bracket to the unit)
  - 3 rubber pads (optional use):  
(attaches to the bottom of the switch)
  - 1 hook-and-loop fastener (optional use):  
(attaches to the bottom of the switch on the Reichert 7)
4. Up/Down Switch: Toggle Switch that moves the Chinrest up or down.

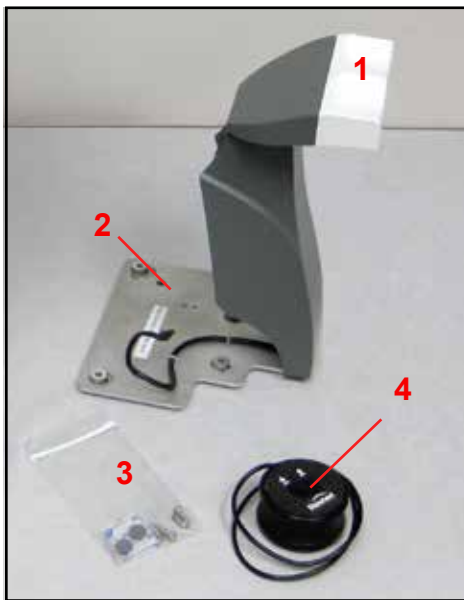

**Figure 1-1, Parts Identification**

# Instrument Setup (Continued)

## Installation

Install the Reichert 7 Series Chinrest assembly according to the following procedure.

**Note:** The Reichert 7 Series Chinrest is compatible with the Reichert 7, Reichert 7CR, and the Ocular Response Analyzer® G3.

1. Set the Reichert 7 on its side so that the Chinrest assembly can be installed onto the bottom of the unit. (Refer to Figure 1-2)
2. Remove the two screws that secure the connector access plate. Remove the access plate and attach the screws from where they were removed to secure the connector interface plate. Put the access plate in with the shipping container for future use, if needed.
3. Attach the Chinrest assembly connector to its mating connector on the bottom of the Reichert 7. (Refer to Figure 1-3)
4. Attach the connector from the UP/Down Switch to the back side of the Chinrest assembly (Refer to Figure 1-4) and run the cable behind the chinrest assembly, between the chinrest assembly and the patient side of the instrument. Continue routing the cable under the instrument so that it is out of view to the patient.
5. Position the Chinrest assembly so that the mounting holes on the Chinrest assembly align with the holes on the bottom of the unit. (Refer to Figure 1-5)
6. Secure the Chinrest assembly to the bottom of the Reichert 7 with the screws supplied with the Chinrest assembly.
7. Attach the three rubber bumpers or the hook-and-loop fasteners to the bottom of the UP/Down Switch as desired. If using the Hook-and-loop fasteners, secure the other side to the other desired surface. (e.g., unit, table, etc.). (Refer to Figure 1-6)

**Note:** There are no fuses in this instrument and disconnection of the Reichert 7 Series Chinrest is performed by removing the connection from the bottom of the instrument.



Figure 1-2, Reichert 7 Bottom



Figure 1-3,

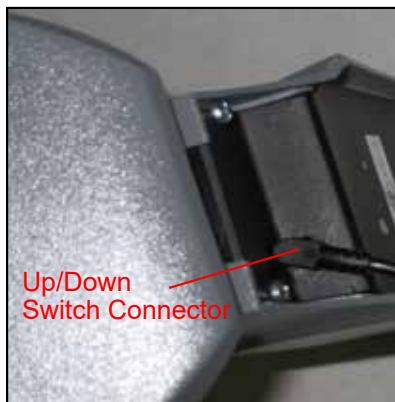

Figure 1-4, Switch Connector



Figure 1-5, Switch Connector

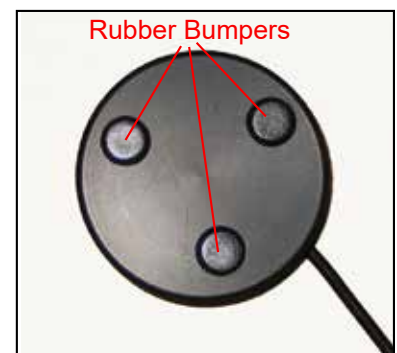

Figure 1-6, Switch Bumpers

# Instructions for Use

## Chinrest Operation

The Chinrest assembly is a device that assists patient alignment during measurement. It allows patients that have difficulty holding still during a measurement to have an additional reference point for reducing movement. The Up/Down Switch should be set on the table next to the unit so that it is easily accessible to operate.

**Note:** The canthus marks on the side of the unit should be aligned vertically near the apex of the eye.

To change the height of the chinrest: (Refer to Figure 1-7)

- Press the up button on the Up/Down Switch to move the chinrest up
- Press the down button on the Up/Down Switch to move the chinrest down.

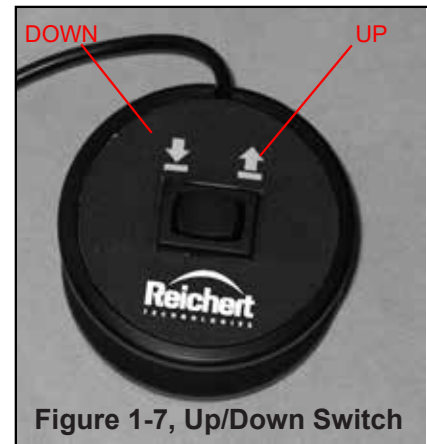



# Cleaning & Maintenance

Perform the following procedures as need to keep this instrument operating correctly.



**CAUTION: DO NOT USE ALCOHOL, SOLVENTS OR STRONG CLEANING SOLUTIONS OR DAMAGE TO THE UNIT WILL OCCUR.**

## External Cleaning

Remove power from the non-contact tonometer and clean the external surfaces of the Chinrest using a clean, soft cloth lightly moistened with a mild detergent solution (1 cc of liquid dish soap to one liter of clean, filtered water (filtered below 5 microns)). Do not allow the mild detergent solution to drip inside the non-contact tonometer or Chinrest Assembly or damage may occur.

There is no scheduled maintenance required for this product.

## Fuse Replacement

There are no fuses in this product.

# Troubleshooting

The following chart provides details of common complaints and solutions for the Reichert 7 Series Chinrest.



**WARNING: DO NOT REMOVE THE OUTSIDE COVERS OF THE UNIT OR ATTEMPT TO REPAIR ANY INTERNAL PARTS. REPAIR AND SERVICE OF THE UNIT MUST BE PERFORMED BY EXPERIENCED REICHERT PERSONNEL OR AUTHORIZED DISTRIBUTORS WHO ARE TRAINED BY REICHERT.**

Details	Probable Cause	Solution
Chinrest does not move Up or Down.	<ul style="list-style-type: none"><li>• Chinrest is not connected to the non-contact tonometer.</li><li>• Up/Down Switch is not connected to non-contact tonometer.</li><li>• Circuit board in the Chinrest assembly is defective.</li></ul>	<ul style="list-style-type: none"><li>• Attach connector to the non-contact tonometer.</li><li>• Attach the connector from the switch to the non-contact tonometer.</li><li>• Replace the Chinrest circuit board.</li></ul>
Chinrest moves left and right and is not locked in position.	<ul style="list-style-type: none"><li>• Chinrest mounting bracket is loose.</li></ul>	<ul style="list-style-type: none"><li>• Tighten mounting bracket on the bottom of the non-contact tonometer.</li></ul>

# General Specifications

REF 16049

## Physical Dimensions

Size:

Height: 11.0 in. (28.0 cm)

Width: 7.25 in. (18.4 cm)

Depth: 8.00 in. (20.3 cm)

Weight, unpacked:

2.59 lbs. (1.17 Kg)

## Electrical

Voltage: 24 VDC

Fuses: None

## Operational Conditions

Environmental:

The environmental conditions are as follows:

Operating:

Temperature 10° C (50° F) to 35° C (95° F)

Relative Humidity: 30% to 75%

Atmospheric Pressure: 80 (23.6 in. Hg) to  
106 kPa (31.3 in. Hg)

Transportation & Storage:

Temperature -40° C (-40° F) to +70° C (158° F).

Relative Humidity: 10% to 80%

Atmospheric Pressure: 50 (14.8 in. Hg) to  
106 kPa (31.3 in. Hg)

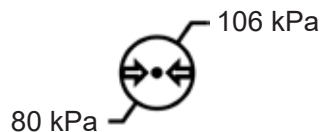
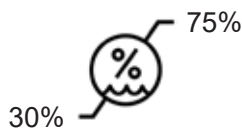

## Disposal

This product does not generate any environmentally hazardous residues. At the end of its product service life, follow your local laws and ordinances regarding the proper disposal of this equipment.

## Software Revision

There is no software associated with this instrument.

## Guidance Tables

Refer to Reichert 7 User's Guide (P/N 16050-101) for details regarding IEC 60601-1-2 guidance tables.

# Warranty

This product is warranted by Reichert, Inc. ("Reichert") against defective material and workmanship under normal use for a period of one year from the date of invoice to the original purchaser. (An authorized dealer shall not be considered an original purchaser.) Under this warranty, Reichert's sole obligation is to repair or replace the defective part or product at Reichert's discretion.

This warranty applies to new products and does not apply to a product that has been tampered with, altered in any way, misused, damaged by accident or negligence, or that has the serial number removed, altered or effaced. Nor shall this warranty be extended to a product installed or operated in a manner not in accordance with the applicable Reichert instruction manual, nor to a product that has been sold, serviced, installed or repaired other than by a Reichert factory, Technical Service Center, or authorized Reichert, Inc. dealer.

Lamps, bulbs, charts, cards and other expendable items are not covered by this warranty.

All claims under this warranty must be in writing directed to the Reichert factory, Technical Service Center, or authorized instrument dealer making the original sale and must be accompanied by a copy of the purchaser's invoice.

This warranty is in lieu of all other warranties implied or expressed. All implied warranties of merchantability or fitness for a particular use are hereby disclaimed. No representative or other person is authorized to make any other obligations for Reichert. Reichert shall not be liable for any special, incidental, or consequent damages for any negligence, breach of warranty, strict liability or any other damages resulting from or relating to design, manufacture, sale, use or handling of the product.

## PATENT WARRANTY

If notified promptly in writing of any action brought against the purchaser based on a claim that the instrument infringes a U.S. Patent, Reichert will defend such action at its expense and will pay costs and damages awarded in any such action, provided that Reichert shall have sole control of the defense of any such action with information and assistance (at Reichert's expense) for such defense, and of all negotiation for the settlement and compromise thereof.

## PRODUCT CHANGES

Reichert reserves the right to make changes in design or to make additions to or improvements in its products without obligation to add such to products previously manufactured.

## CLAIMS FOR SHORTAGES

We use extreme care in selection, checking, rechecking and packing to eliminate the possibility of error. If any shipping errors are discovered:

1. Carefully go through the packing materials to be sure nothing was inadvertently overlooked when the unit was unpacked.
2. Call the dealer you purchased the product from and report the shortage. The materials are packed at the factory and none should be missing if the box has never been opened.
3. Claims should be filed within 30 days.

## CLAIMS FOR DAMAGES IN TRANSIT

Our shipping responsibility ceases with the safe delivery in good condition to the transportation company. Claims for loss or damage in transit should be made promptly and directly to the transportation company.

If, upon delivery, the outside of the packing case shows evidence of rough handling or damage, the transportation company's agent should be requested to make a "Received in Bad Order" notation on the delivery receipt. If within 48 hours of delivery, concealed damage is noted upon unpacking the shipment and no exterior evidence of rough handling is apparent, the transportation company should be requested to make out a "Bad Order" report. This procedure is necessary in order for the dealer to maintain the right of recovery from the carrier.



Manufactured By  
**Reichert, Inc.**  
3362 Walden Ave  
Suite 100  
Depew, NY 14043  
USA

Toll Free 888-849-8955  
Phone: 716-686-4500  
Fax: 716-686-4555  
Email: [reichert.information@ametek.com](mailto:reichert.information@ametek.com)  
[www.reichert.com](http://www.reichert.com)

Authorized European Representative  
**Emergo Europe**  
Prinsessegracht 20  
2514 AP The Hague  
The Netherlands  
Tel: (31) (0) 70 345-8570  
Fax: (31) (0) 70 346-7299  
Email: [EmergoVigilance@ul.com](mailto:EmergoVigilance@ul.com)

ISO 13485 Certified



16049-101 Rev. E

March 6, 2020

