



# The One and Only DOLE SOFT SERVE® RECIPE & RESOURCE GUIDE



*Featuring*

**DOLE® Chef-Ready Cuts & DOLE®  
100% Pineapple Juice for select recipes.**

### PINEAPPLE SUNRISE FLOAT

1. Prepare DOLE SOFT SERVE® Pineapple-Flavored as directed
2. Prepare DOLE SOFT SERVE® Strawberry-Flavored as directed
3. Fill vessel with prepared twist of 5 oz DOLE SOFT SERVE® Pineapple-Flavored + DOLE SOFT SERVE® Strawberry-Flavored
4. Top finished product with 1+oz of orange juice

### CLASSIC PINEAPPLE FLOAT

1. Prepare DOLE SOFT SERVE® Pineapple-Flavored as directed
2. Dispense 5 oz of prepared DOLE SOFT SERVE® Pineapple-Flavored in a serving vessel
3. Pour 3 oz. of *DOLE® 100% Pineapple Juice* around the soft serve
4. Garnish with pineapple wedge

### ORANGE DREAM-TICKLER

1. Prepare DOLE SOFT SERVE® Orange-Flavored as directed
2. Dispense 5 oz of prepared DOLE SOFT SERVE® Orange-Flavored in serving vessel
3. Pour 1+ oz of cream soda over soft serve

## RECIPE INSPIRATIONS



### MOSCOW MOCKTAIL

1. Fill cup with approximately 4 oz prepared DOLE SOFT SERVE® Lime-Flavored
2. Top product with 5 oz of ginger beer or ginger ale
3. Garnish with fresh lime wedge



### COCONUT MANGO FLOAT

1. Prepare DOLE SOFT SERVE® Mango-Flavored as directed
2. Pour 0.5 oz of coconut milk onto 5 oz of soft serve
3. Pour 0.5 oz of *DOLE® 100% Pineapple Juice* onto soft serve
4. Garnish with shaved coconut and *DOLE® Chef-Ready Cuts Mango Cubes IQF*



### ORANGE PINEAPPLE FLOAT

1. Prepare DOLE SOFT SERVE® Orange-Flavored as directed
2. Dispense 5 oz of prepared DOLE SOFT SERVE® Orange-Flavored in serving vessel
3. Pour 1+ oz of *DOLE® 100% Pineapple Juice* around the soft serve



### POMEGRANATE COCONUT SHAKE

1. Dispense 1 ½ cup prepared DOLE SOFT SERVE® Pomegranate-Flavored from the soft serve machine into a stainless mixing cup
2. Add 2 cups crushed ice, ¾ cup coconut milk, and ½ cup ice water to the soft serve
3. Using a drink blender (i.e. milkshake spinner or concrete blender etc.) blend all ingredients until smooth, about 1 minute
4. Pour into chilled glasses and garnish with 1 Tbsp pomegranate seeds and 1 Tbsp coconut flakes (optional)



Take your recipes to the next level with  
**DOLE® 100% Pineapple Juice,**  
**DOLE® Chef-Ready Cuts and**  
**DOLE® Smoothie Cuts.**



### CHERRY COLA FLOAT

1. Prepare DOLE SOFT SERVE® Cherry-Flavored as directed
2. Place a 5 oz serving of prepared DOLE SOFT SERVE® Cherry-Flavored in a serving dish
3. Top with approx 1+ oz of cherry cola on top of 5 oz of finished DOLE SOFT SERVE® Cherry-Flavored



### MANGO VANILLA CHEESECAKE

1. Prepare DOLE SOFT SERVE® Mango-Flavored as directed
2. Fill vessel with finished 5 oz DOLE SOFT SERVE® Mango-Flavored
3. Drizzle 0.5+ oz white chocolate sauce
4. Top with 1 tbsp. of cheesecake bites and 1 tsp. of graham cracker crumbs



### CHERRY S'MORES

1. Prepare DOLE SOFT SERVE® Cherry-Flavored as directed
2. Add marshmallow pieces, graham cracker cookies and chocolate pieces on top of 5 oz of finished DOLE SOFT SERVE® Cherry-Flavored
3. Drizzle on top of finished DOLE SOFT SERVE® Cherry-Flavored, approx ½ oz. of chocolate sauce and add cherry



### CHOCOLATE RASPBERRY DIVINE

1. Prepare DOLE SOFT SERVE® Raspberry-Flavored as directed
2. Fill vessel with 5 oz DOLE SOFT SERVE® Raspberry-Flavored
3. Top finished product with chocolate syrup and white chocolate syrup
4. Add brownie chunks around soft serve
5. Garnish with *DOLE® Smoothie Cut Raspberry Crumbles*



### POMEGRANATE CITRUS SHAKE

1. Dispense 1 ½ cup prepared DOLE SOFT SERVE® Pomegranate-Flavored from the soft serve machine into a stainless mixing cup
2. Add ¾ cup orange juice and 1 cup ice water to the soft serve. Mix in drink blender until smooth, about 1 minute.
3. Pour into chilled glasses and garnish with whipped cream and pomegranate seeds

### LEMON FLOAT

1. Prepare DOLE SOFT SERVE® Lemon-Flavored as directed
2. Dispense 6 oz. serving of prepared DOLE SOFT SERVE® Lemon-Flavored in a glass
3. Pour 4 oz lemon lime soda over top
4. Serve with a straw

### KEY LIME PIE

1. Fill vessel with approximately 5 oz prepared DOLE SOFT SERVE® Lime-Flavored
2. Top soft serve with caramel syrup
3. Sprinkle with graham cracker crumbs
4. Garnish with fresh lime wedge



# COMPLIMENTARY POINT OF SALE



Brand Standards Guide



Posters 22in x 28in



Sell Sheets



Full Line Brochure

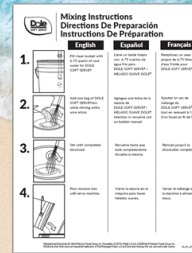

Mixing Instructions



Table Tents  
4in x 6in



Flavor Tags 7in x 5in



Flavor Magnets 5in x 2in

- Order your complimentary POS at [www.DoleSoftServe.com](http://www.DoleSoftServe.com) under Operator POS (all flavors available for each signage type above).
- Download the DOLE SOFT SERVE® Brand Standards Guide at [www.DoleSoftServe.com](http://www.DoleSoftServe.com) under Marketing

## SOFT SERVE BEST PRACTICES

### STORAGE SHELF LIFE

- DOLE SOFT SERVE® Mix 18 Months when stored unopened in a cool dry place

### HANDLING

- Dry Mixes should be rotated following the "First In - First Out" principle and should not be used beyond their code or best-by date
- Transferring mix to the freezer supply tank should be done in a manner that prevents contamination; wear gloves, use sanitized utensils, do not recover spilled product
- Keep fresh sanitizer solution handy; use clean towels immersed in sanitizer solution for clean-ups

### CLEANING & SANITATION

- Follow the manufacturers' instructions for your specific equipment cleaning procedure
- The washed parts should be allowed to air dry and inspected before they are sanitized and reassembled
- Only properly formulated cleaners and approved sanitizers should be used.
- Common household and glassware detergents are not satisfactory for cleaning soft serve/ice cream freezers



### Product Specs

### Nutritional Claims

Flavor	Mfr Code	DOT Code	UPC	Case Pack	Servings/ Case	Servings/ Bag	Serving Size (Prepared)	Dairy Free	No Cholesterol	Gluten Free	Lactose Free	Vegan	Kosher	Low Fat
<b>DOLE SOFT SERVE®</b>														
Pineapple Naturally & Artificially Flavored	D581-A6120	560382	10072058610194	4/4.4 lbs	288	72	5 oz	•	•	•	•	•	•	•
Orange With Other Natural Flavors	D531-A6120	560386	10072058610910	4/4.4 lbs	288	72	5 oz	•	•	•	•	•	•	•
Raspberry With Other Natural Flavors	D551-A6120	576152	10072058611818	4/4.6 lbs	288	72	5 oz	•	•	•	•	•	•	•
Lemon Naturally Flavored	D585-A6448	605490	10072058614949	4/4.4 lbs	288	72	5 oz	•	•	•	•	•	•	•
Mango With Other Natural Flavors	D561-A6120	576123	10072058611900	4/4.5 lbs	288	72	5 oz	•	•	•	•	•	•	•
Strawberry With Other Natural Flavors	D542-A6120	632335	10072058615533	4/4.5 lbs	288	72	5 oz	•	•	•	•	•	•	•
Lime Naturally Flavored	D586-A6120	671891	10072058619418	4/4.4 lbs	288	72	5 oz	•	•	•	•	•	•	•
Cherry With Other Natural Flavors	D571-A6120	707521	10072058621411	4/4.5 lbs	288	72	5 oz	•	•	•	•	•	•	•
Watermelon Artificially Flavored	D520-A6120	716218	10072058621855	4/4.5 lbs	288	72	5 oz	•	•	•	•	•	•	•
Pomegranate-Flavored With Other Natural Flavors	D594-A6120	743027	10072058633100	4/4.4 lbs	288	72	5 oz	•	•	•	•	•	•	•

For more product information on how DOLE SOFT SERVE® can support the profitability of your operations with versatile, delectable frozen treats from a dry mix, contact

Kent Precision Foods Group at **800-442-5242. [DoleSoftServe.com](http://DoleSoftServe.com)**

For more information about DOLE® Chef-Ready Cuts and Smoothie Cut Crumbles, go to [DoleFoodservice.com](http://DoleFoodservice.com)

Manufactured Exclusively By: Kent Precision Foods Group, Inc. Muscatine, IA 52761 Made in U.S.A. ©2022 Kent Precision Foods Group, Inc. DOLE and other Dole marks are registered trademarks of Dole Packaged Foods, LLC and Dole Asia Holdings Pte. Ltd. and used under license.  
2022 Dole Packaged Foods, LLC.

DL\_RECIPE\_22B